

 hachette
PARTWORKS LTD

U 96

U-BOAT

Pack 14

Kits 53-56



BUILD THE ICONIC WORLD WAR II U-BOAT

U 96

U-BOAT

Pack 14

Assembly Instructions

Kit 53: Non-commissioned officers' compartment (IV)

Kit 54: Non-commissioned officers' compartment (V)

Kit 55: The next circuit board

Kit 56: Port hull section



Hachette Partworks Ltd
4th Floor, Jordan House,
47 Brunswick Place, London, N1 6EB
www.U96-collection.com

© 2023/2024 Hachette Partworks Ltd.
ALL RIGHTS RESERVED
Not suitable for children under 14.

WARNING: All parts belong to a kit.
Collectors' item for adults. Not suitable for
children under 14. Some parts may have
sharp edges, please handle them with care.

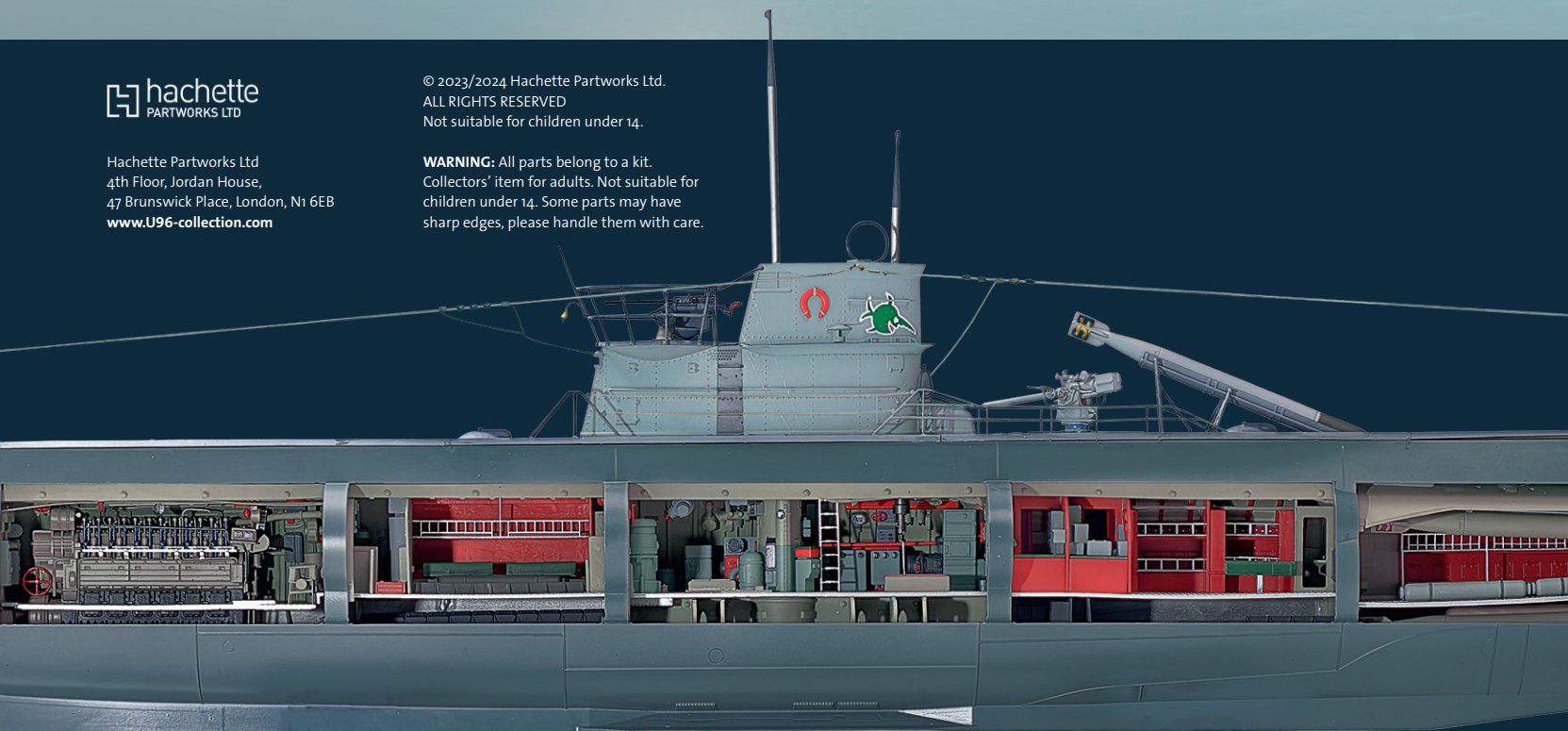

Kit 53: Non-commissioned officers' compartment (IV)

Work on the compartment continues with the forward bulkhead, to which various items including a bulkhead hatch, several fuse boxes and a refrigeration unit are attached.

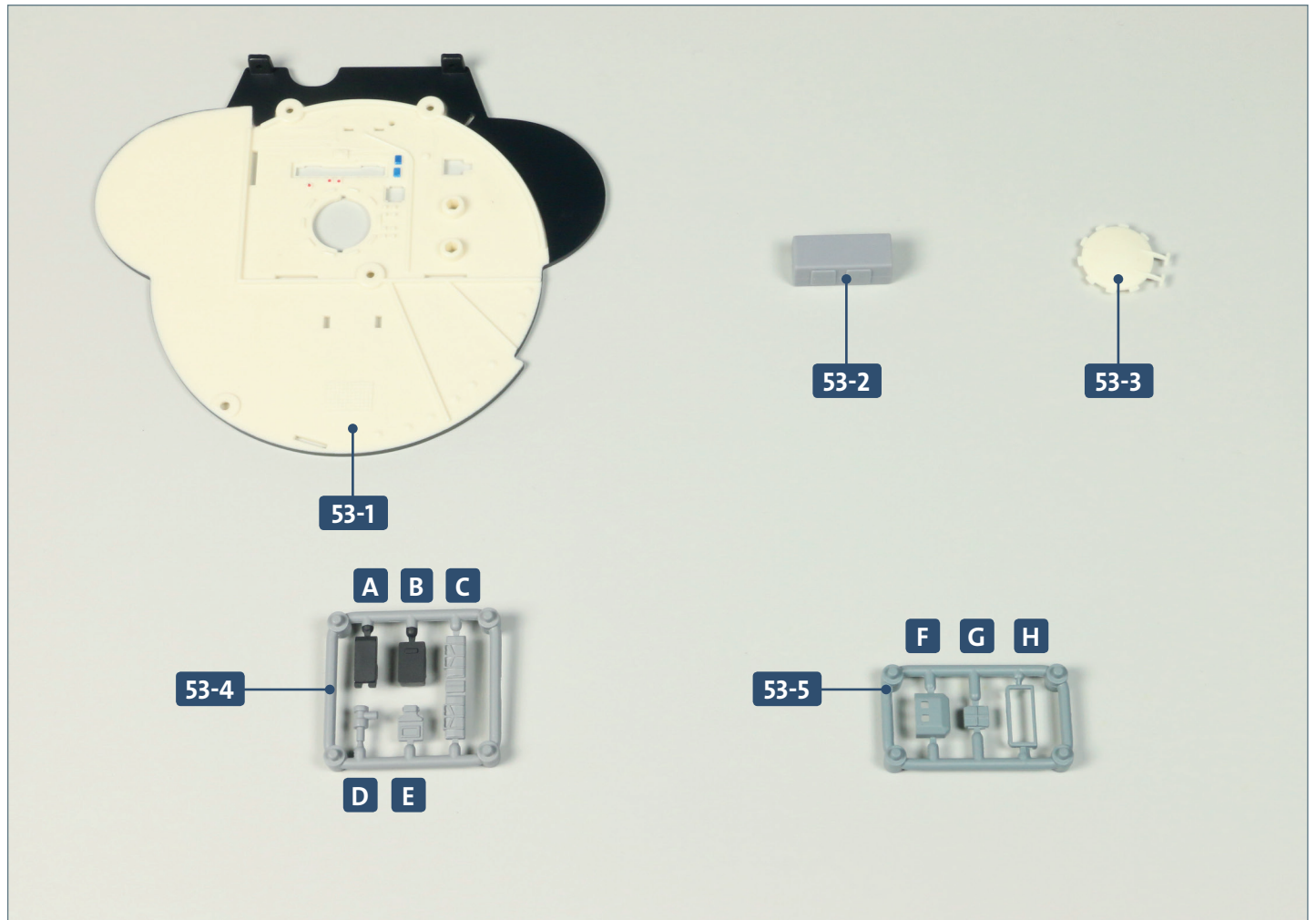

Parts reference list

Part no.	Name
53-1	Forward bulkhead
53-2	Refrigeration unit
53-3	Bulkhead hatch
53-4	Frame (A, B, C, D, E)
53-5	Frame (F, G, H)

Kit 53: Non-commissioned officers' compartment (IV)

STAGE 1 → The forward bulkhead

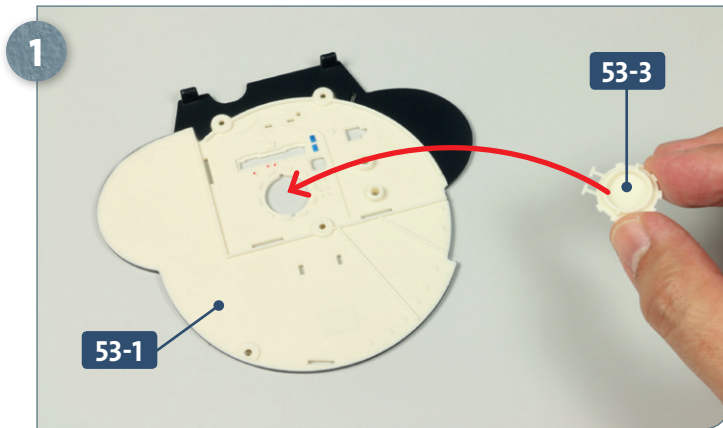

Place the forward bulkhead **53-1** on your work surface. Take the bulkhead hatch **53-3**, apply some glue to the inside of the part, and insert it into the central opening in the bulkhead **53-1**, as shown in the next step and indicated by the arrow.

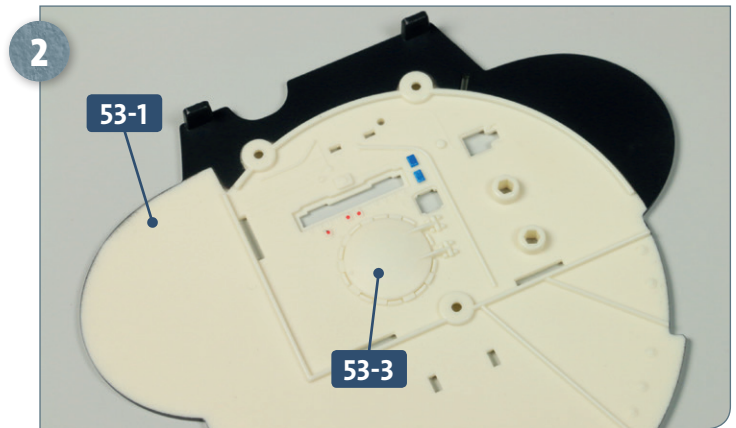

This photograph shows the bulkhead hatch **53-3** installed in the central opening in the bulkhead **53-1**, with the hinges correctly seated in the mounts.

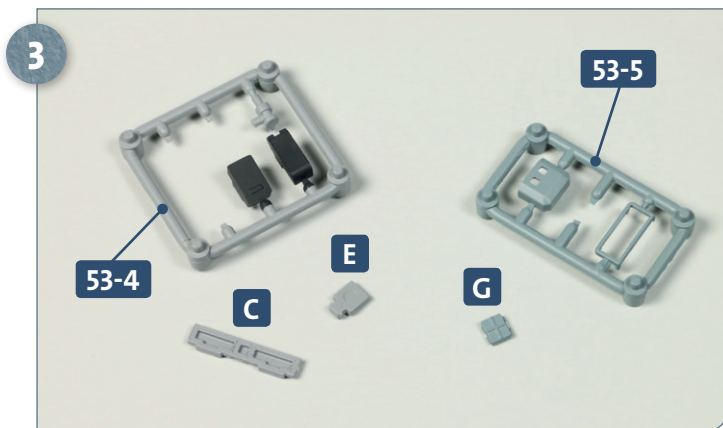

Detach parts **C** and **E** from frame **53-4** and part **G** from frame **53-5**, as shown in the photo.

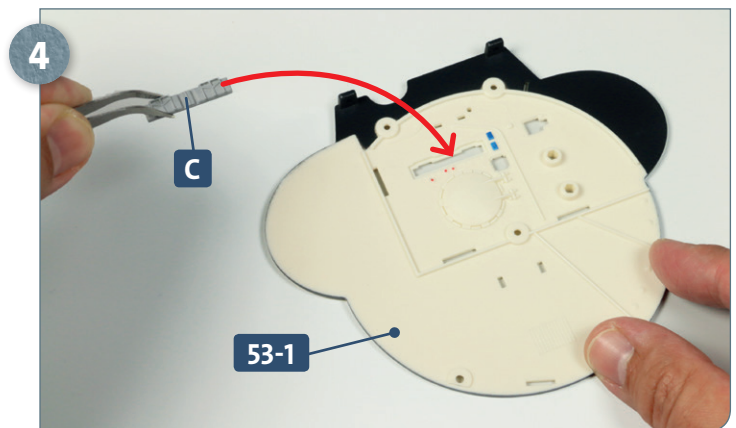

Take part **C**, apply some glue to its lower edge and insert into the elongated recess in the bulkhead **53-1**, as indicated by the arrow.

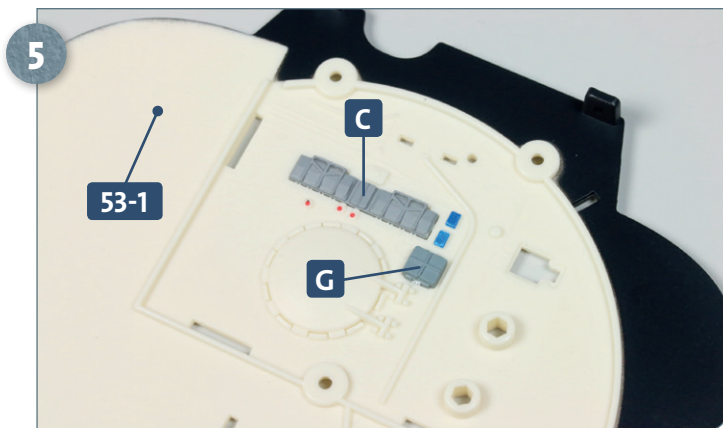

Once part **C** is attached to the bulkhead **53-1**, glue part **G** diagonally below it, as pictured above.

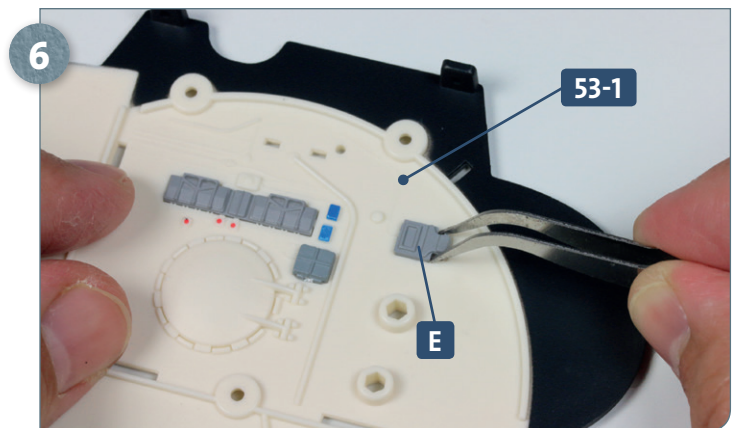

Apply some glue to the edge of part **E** and attach it to the bulkhead **53-1**, as shown above.

Non-commissioned officers' compartment (IV)



Take the refrigeration unit **53-2** and apply some glue to the pegs on the back. After checking the orientation of the detail in the next step, fit the pegs into the two raised sockets on the bulkhead **53-1**, as shown by the red arrows, left.

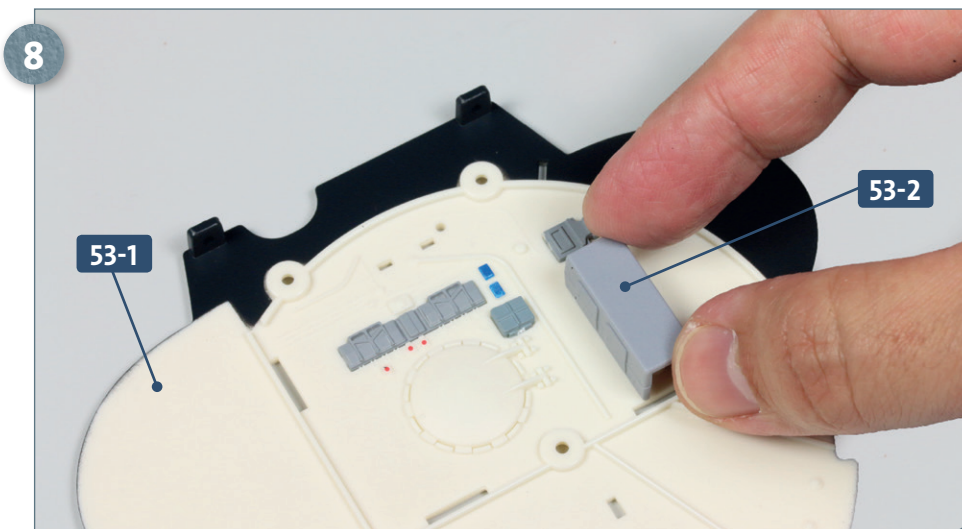

This photo shows the refrigeration unit **53-2** with the pegs inserted into the sockets in the bulkhead **53-1**.

COMPLETED WORK

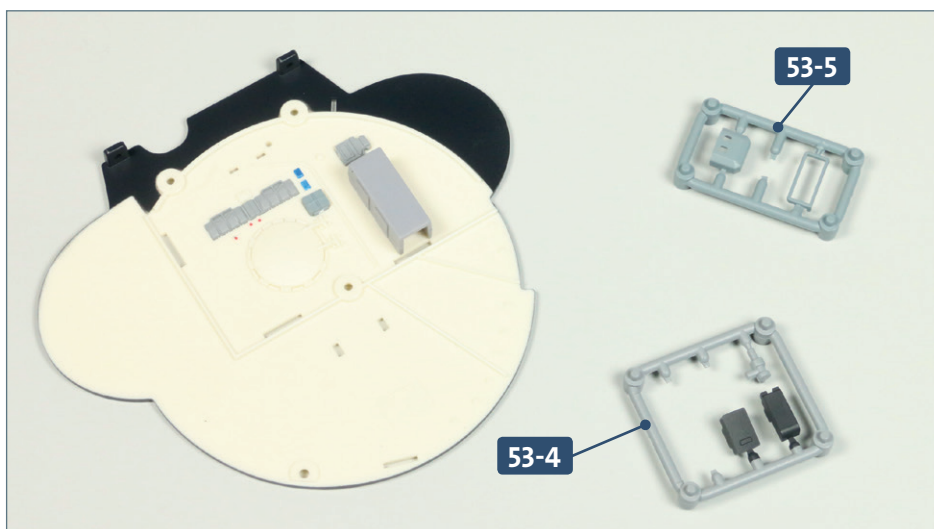

Work has begun on the forward bulkhead of the fourth compartment. Keep frames **53-4** and **53-5** and their five remaining parts somewhere safe, for use in a future kit.

Kit 54: Non-commissioned officers' compartment (V)

Work on the fourth compartment continues with the galley: the stove is fitted with a gimbal and attached to the aft bulkhead, along with the extractor hood. Two doors are also installed.

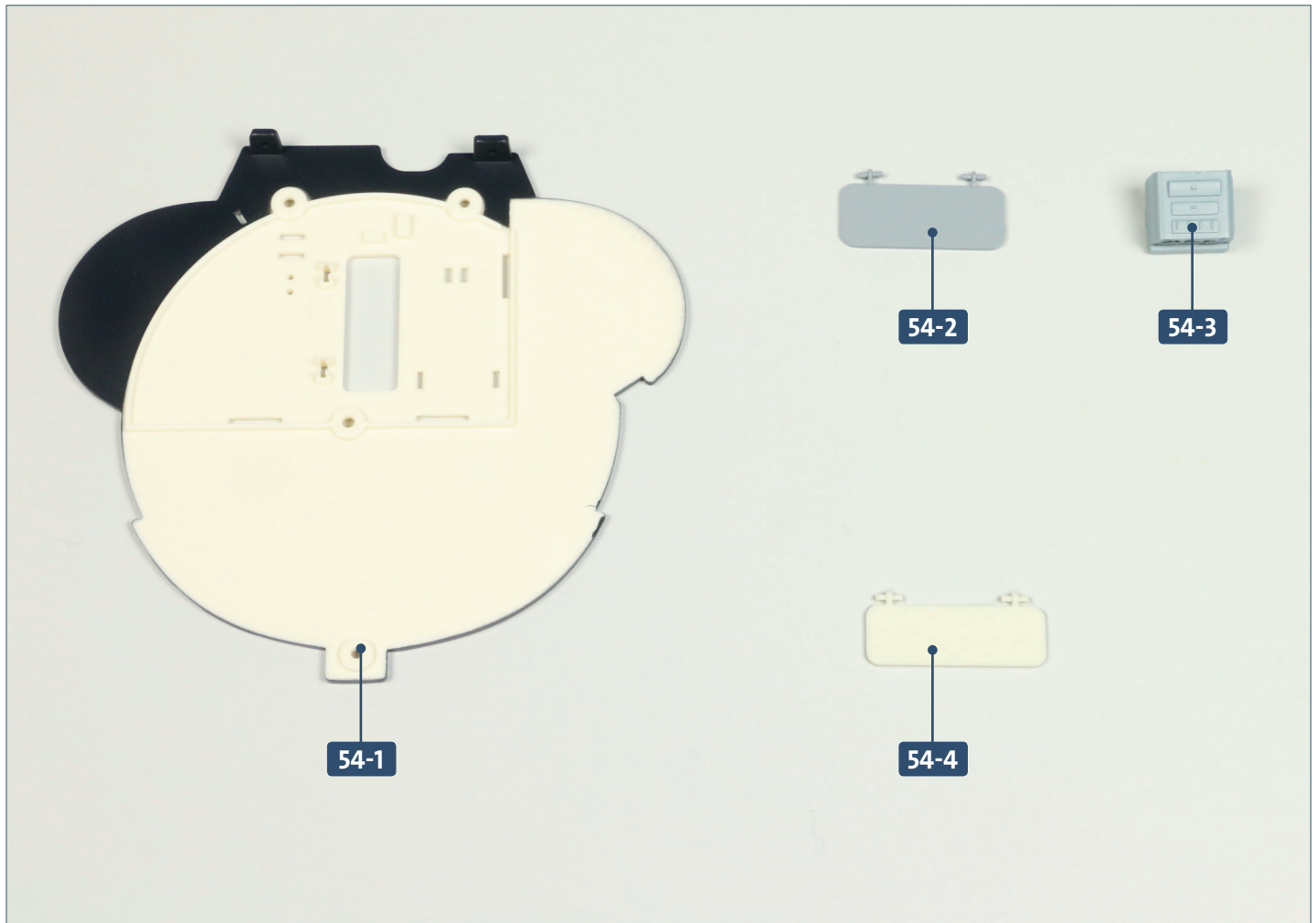

Parts reference list

Part no.	Name
54-1	Aft bulkhead
54-2	Door
54-3	Stove
54-4	Door

Kit 54: Non-commissioned officers' compartment (V)

STAGE 1 → The fourth compartment (continued)

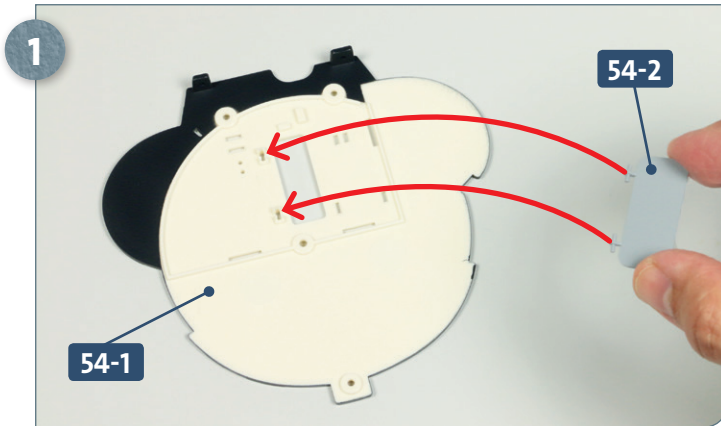

Place the aft bulkhead 54-1 on your work surface, positioned as shown above. Take the door 54-2 and push-fit its two hinges into the slots on the bulkhead, as indicated.

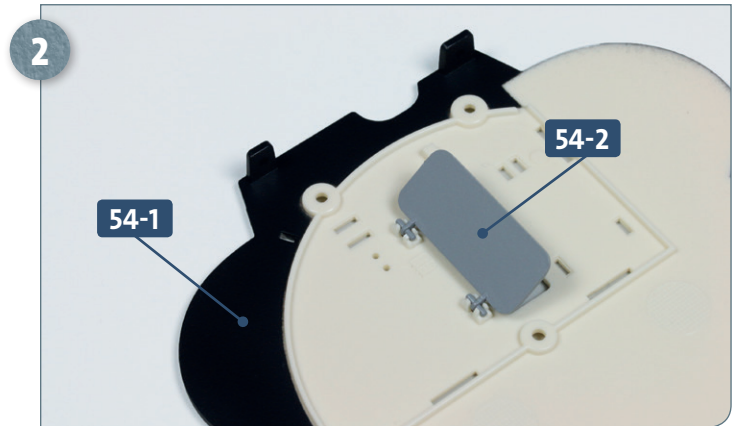

The photo shows the door 54-2 attached to the bulkhead 54-1: do not glue it in place; it needs to be able to move.

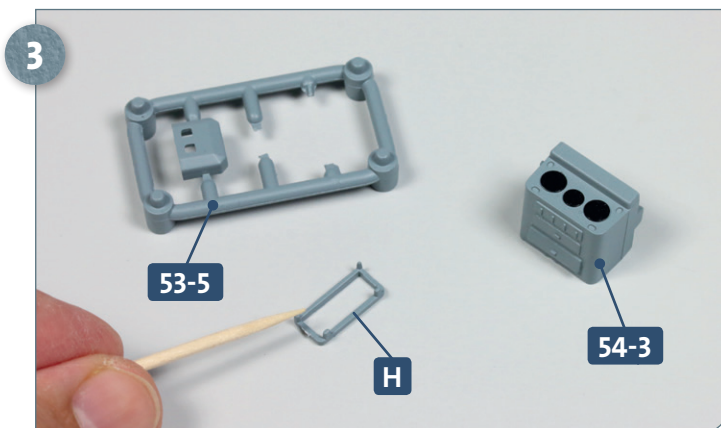

Place the stove 54-3 on your work surface. Detach part H, the gimbal for the stove, from frame 53-5, which was supplied with the previous kit. Add a little glue to each of the four feet on the underside of part H.

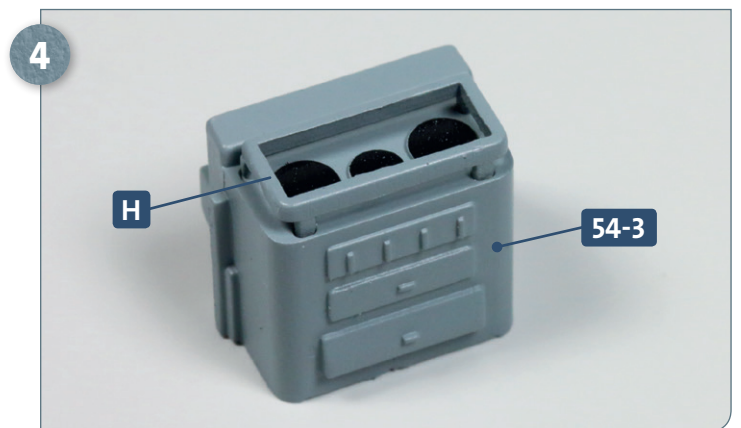

Glue the gimbal H into the small recesses of the stove 54-3, as pictured above.

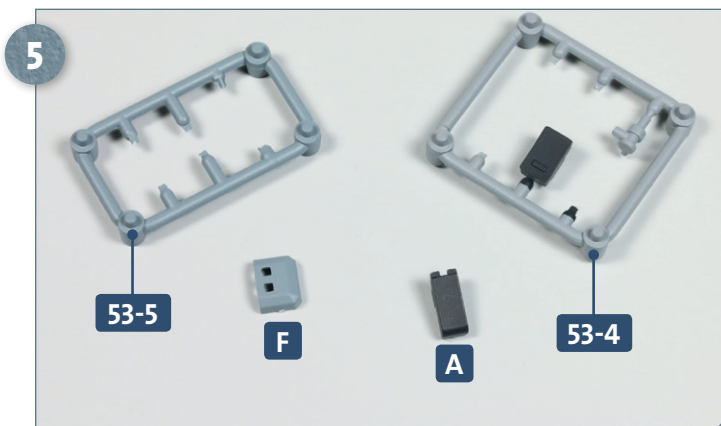

Next, assemble the stove's extractor hood. First, separate part A from frame 53-4 and part F from frame 53-5.

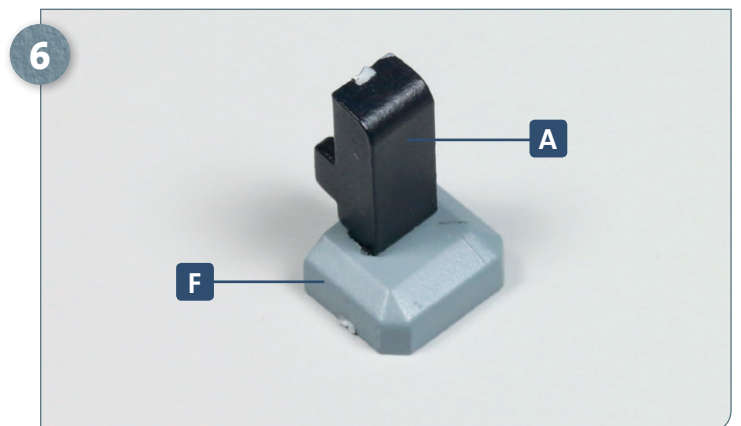

After test-fitting, apply some glue to the two feet of part A and fit them into the corresponding slots in part F.

Kit 54: Non-commissioned officers' compartment (V)

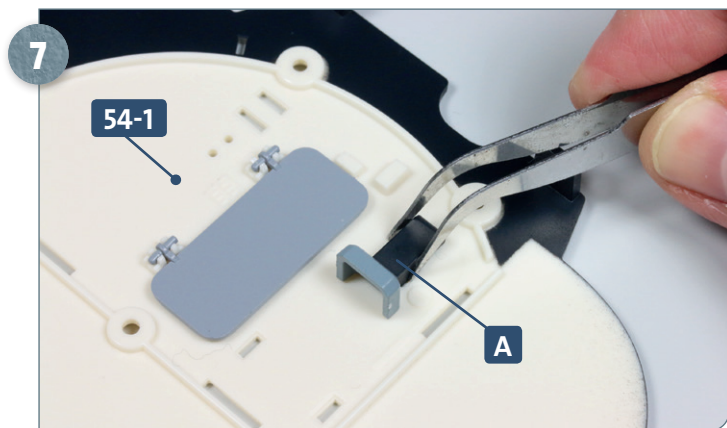

Apply some glue to the two pegs on the back of **A** before inserting these into the two vertical slots in bulkhead **54-1**, as shown above.

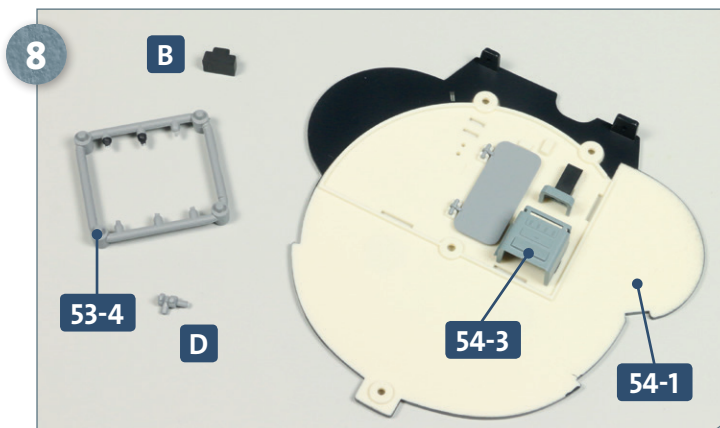

The stove **54-3** is glued into the corresponding slots in the bulkhead **54-1** below the extractor hood. Separate the two remaining parts, **B** and **D**, from frame **53-4**.

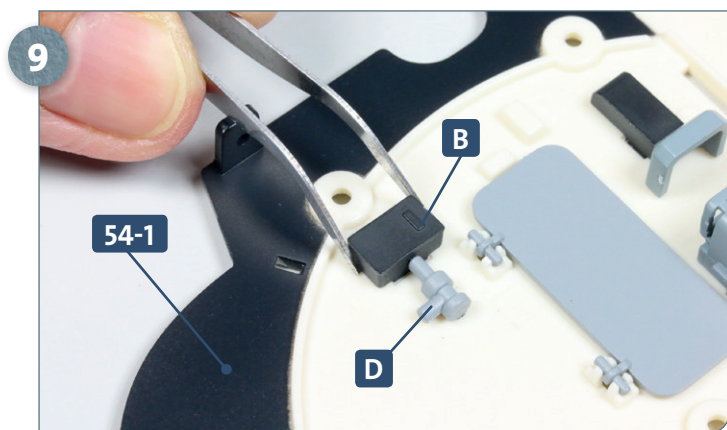

Apply some glue to the two pegs on parts **B** and **D** and attach them to the slots on the bulkhead **54-1**, as pictured.

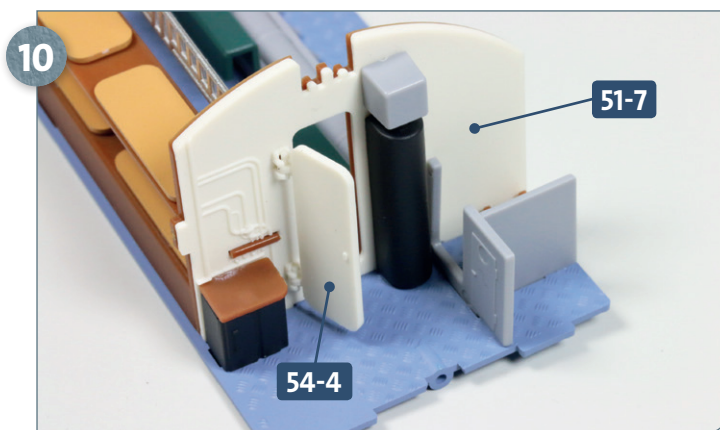

Take the door **54-4** and fit its hinge into the mounts on the partition **51-7**. The door should remain movable, as shown.

COMPLETED WORK

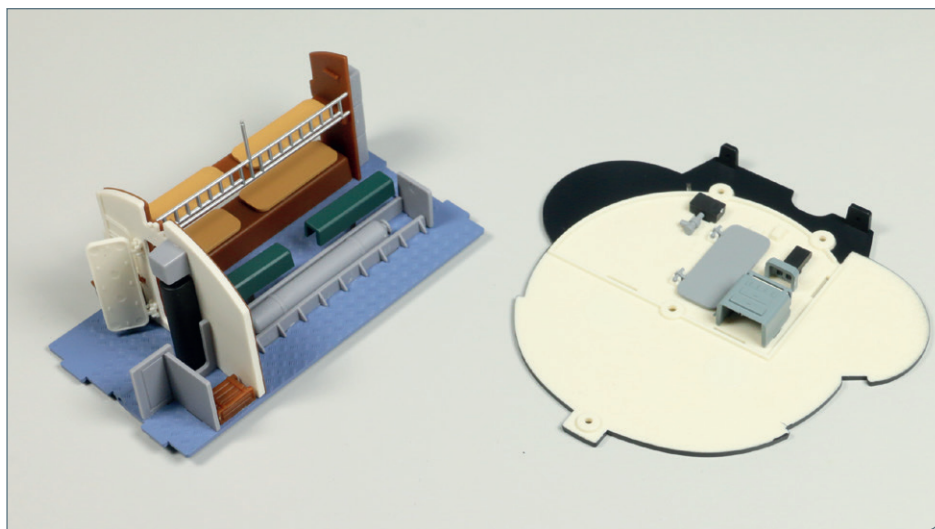

Various parts have been attached to the aft bulkhead of the fourth compartment, and a door fitted to the galley partition bulkhead.

Kit 55: The next circuit board

In this kit, you will fit a cover to a circuit board, connect various cables and then attach the cover to the back of the command room.

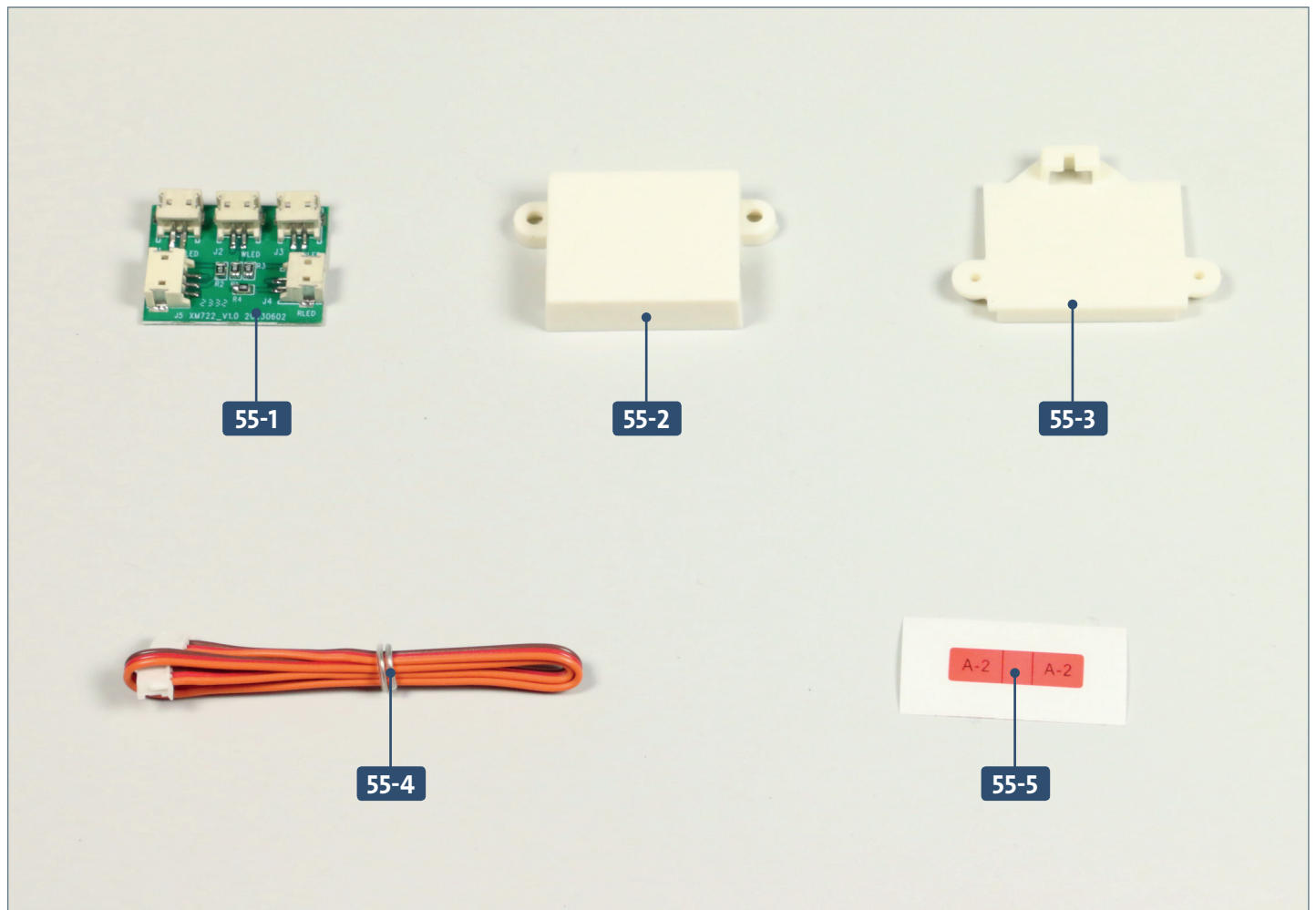

Parts reference list	
Part no.	Name
55-1	Printed circuit board (PCB)
55-2	Front cover for PCB
55-3	Back cover for PCB
55-4	Cable
55-5	Cable label



Screws		
Ref	No.	Dimensions
AP	2+1	2 x 4 mm

Kit 55: The next circuit board

STAGE 1 → Assembly and wiring of the PCB

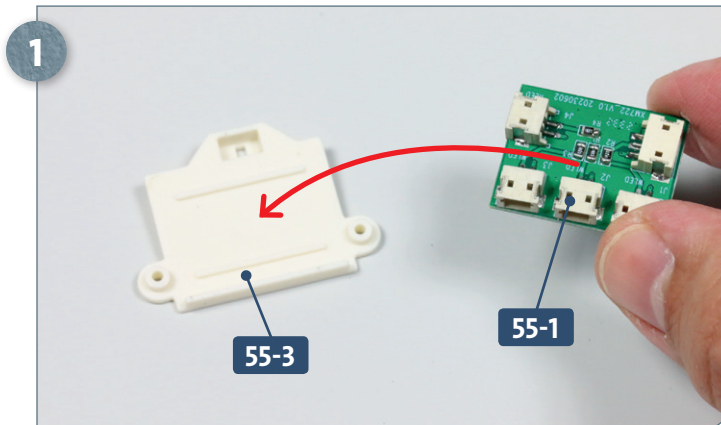

Lay the back cover of the circuit board **55-3** on your work surface. Take the PCB **55-1** and place it onto the back cover **55-3**, as indicated by the arrow.

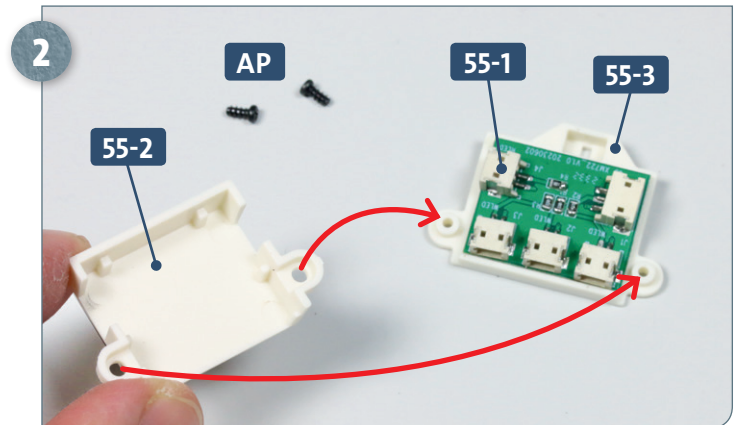

Once the PCB **55-1** is in position on the back cover **55-3**, place the front cover **55-2** over the top, as indicated by the arrows. Have ready two **AP** screws.

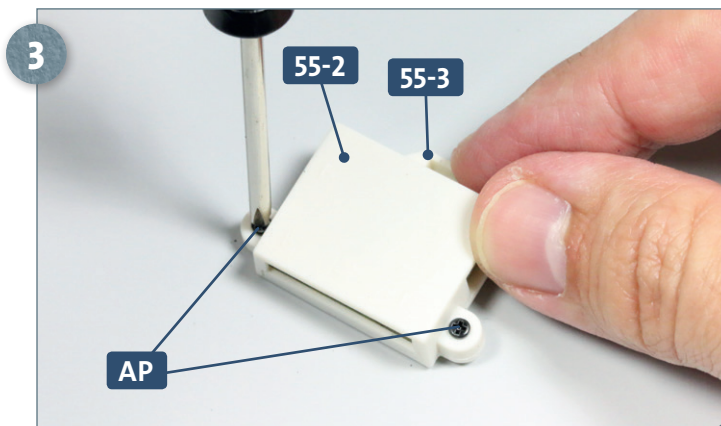

Attach the two halves of the cover **55-2** and **55-3** together using the two **AP** screws.

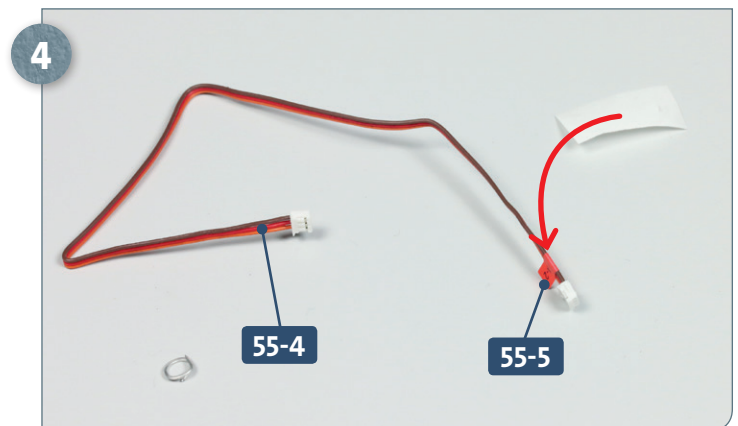

Next, prepare cable **55-4**. Remove the cable label **55-5** from its backing film and attach it near to one of the terminals on the cable, as shown. It does not matter to which end of the cable the label is attached.

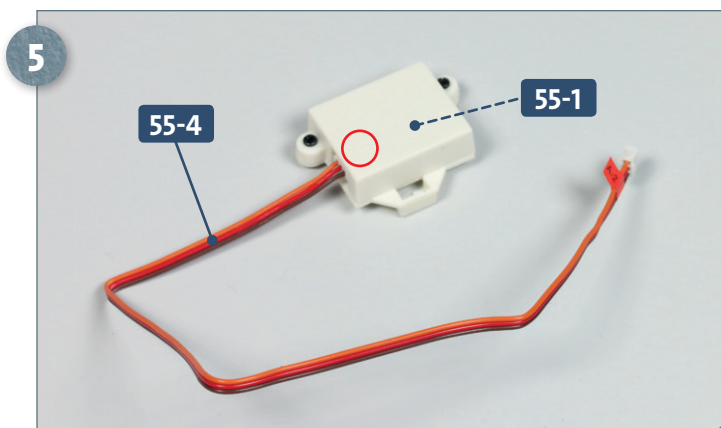

Insert the end of the cable **55-4** with no cable label attached into socket 5 (circled) of the PCB **55-1**, as pictured.

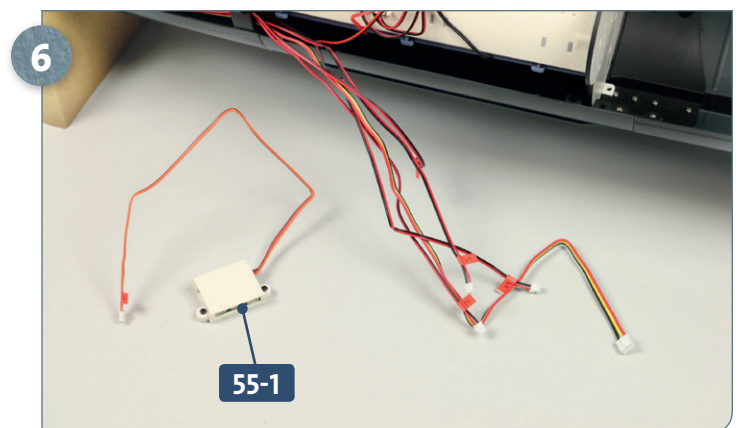

Place the PCB **55-1** assembly near the centre at the forward port (L) side of the hull structure, as shown.

Kit 55: The next circuit board

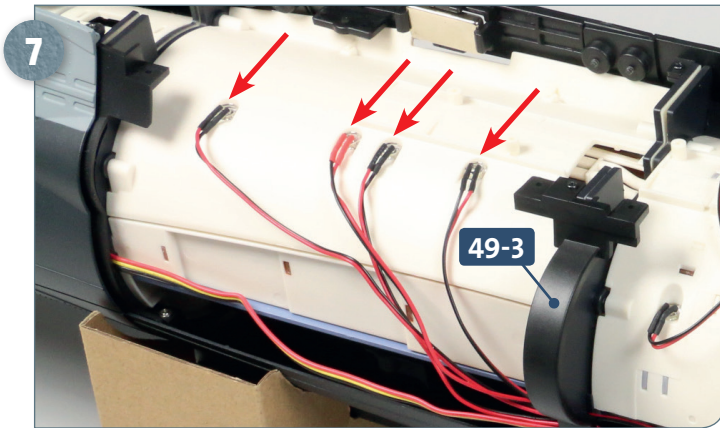

The three LED cables **28-7** marked **L-1** and cable **28-6** marked **L-2** from the second compartment (see red arrows) are now connected to the PCB **55-1**. These were previously routed behind bracket **49-3**.

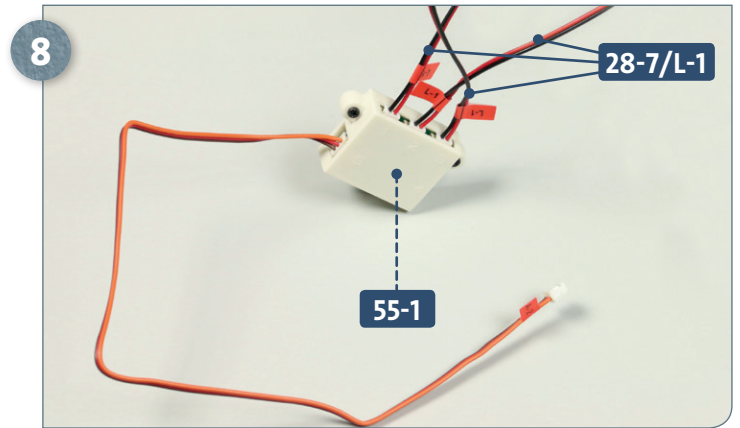

Insert the connectors of the three cables **28-7** marked **L-1** into sockets 1, 2 and 3 of the PCB **55-1**, as shown.

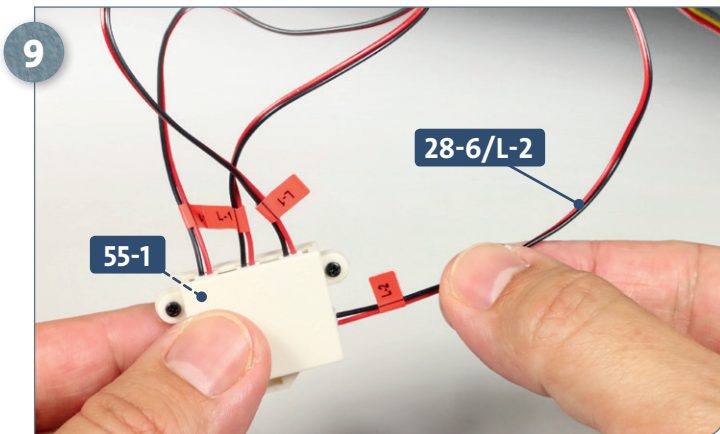

Cable **28-6**, marked **L-2**, is then connected to socket 4 of the PCB **55-1**.

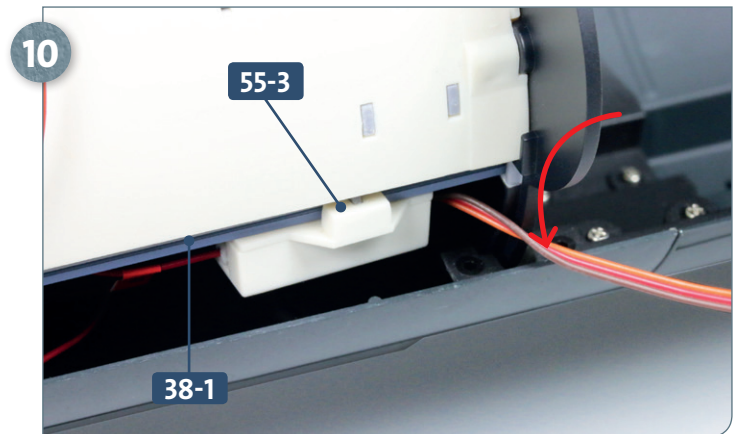

Fit the PCB assembly to the base plate of the control panel **38-1**: the slot on the back cover of the circuit board **55-3** accommodates the tab on the base plate **38-1**, as pictured. Do not glue in place.

COMPLETED WORK

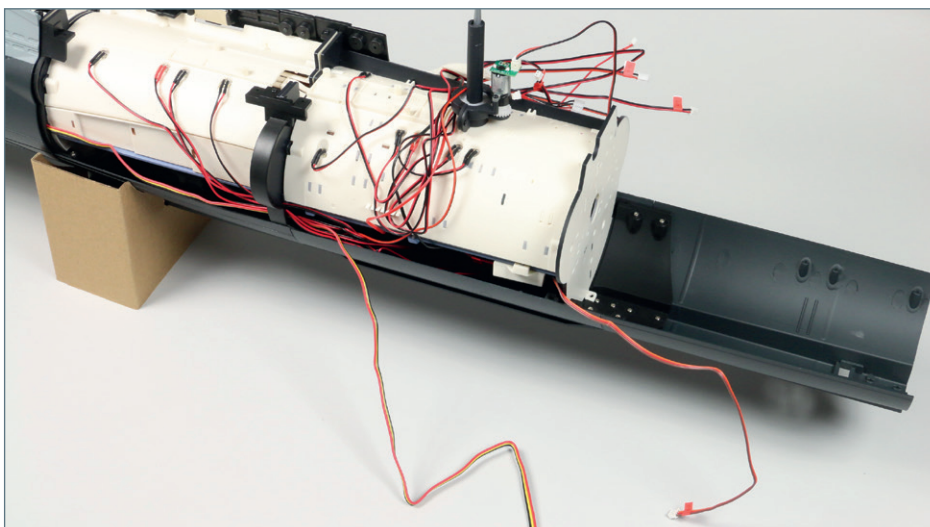

Five cables have now been connected to the supplied circuit board (PCB), which has then been attached to the aft section of the command compartment.

Kit 56: Port hull section

In this kit, the assembly of the hull progresses, with an additional port (L) section.

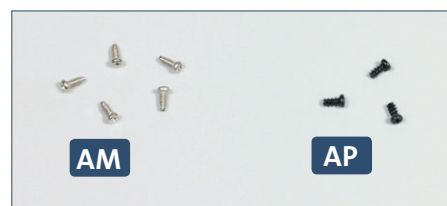
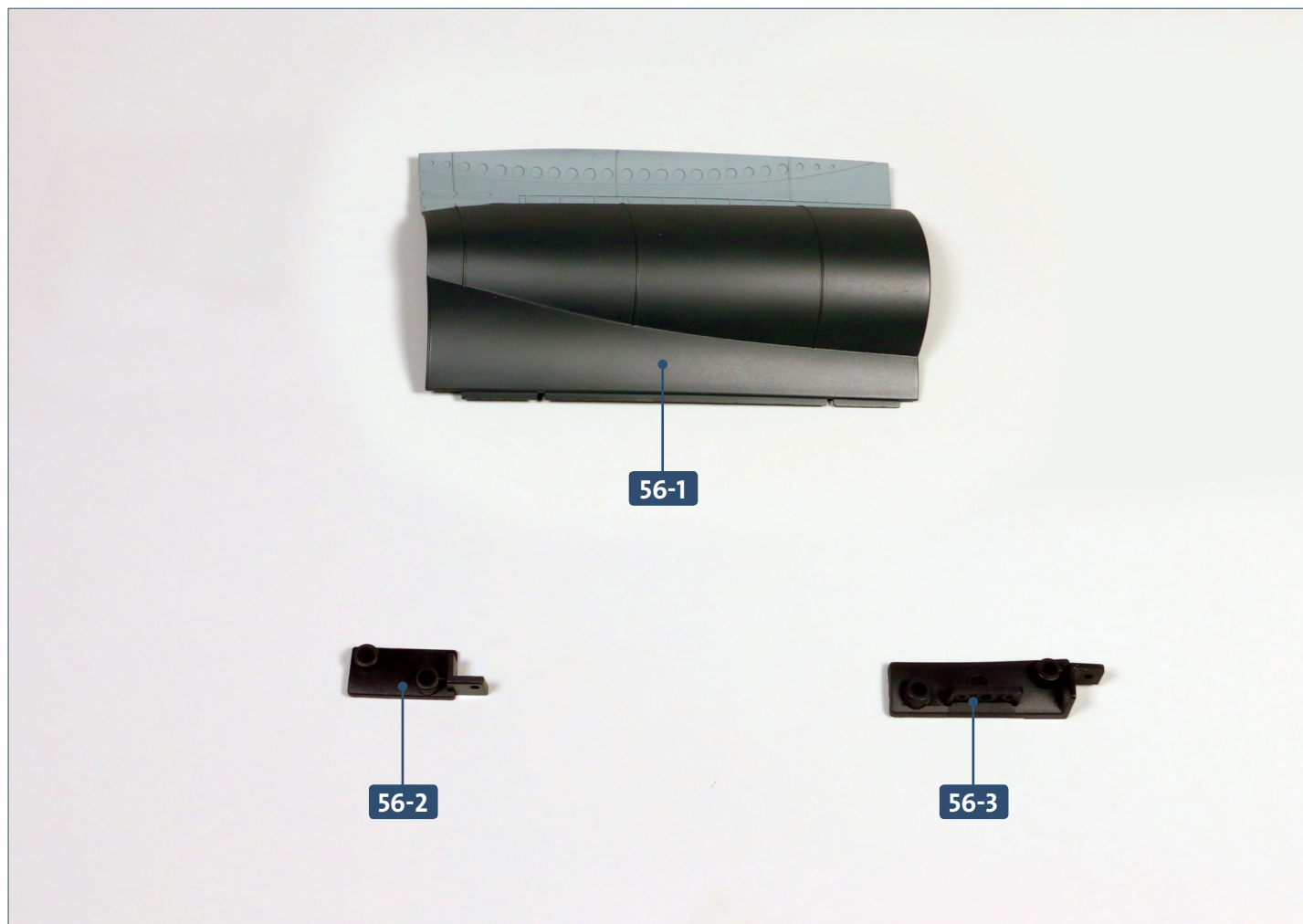

Parts reference	
Part no.	Name
56-1	Port (L) hull plate
56-2	Connector
56-3	Connector

Screws		
Ref	No.	Dimensions
AM	4+1	2 x 4 mm
AP	2+1	2 x 4 mm

STAGE 1 → Assembly of the new hull plate

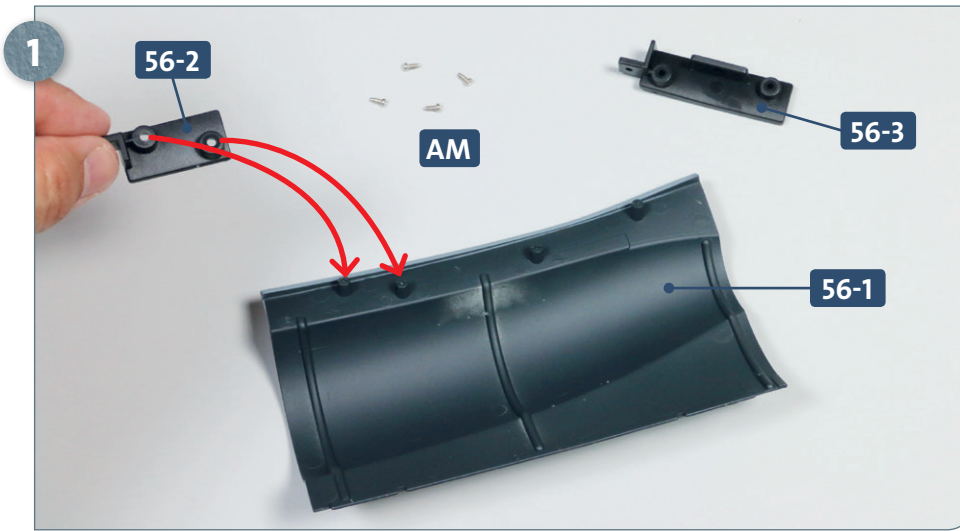

Place hull plate 56-1 face down on your work surface. Have ready the two connectors 56-2 and 56-3 and four AM screws. First take connector 56-2 and fit it over the raised screw sockets on the hull plate, as indicated.

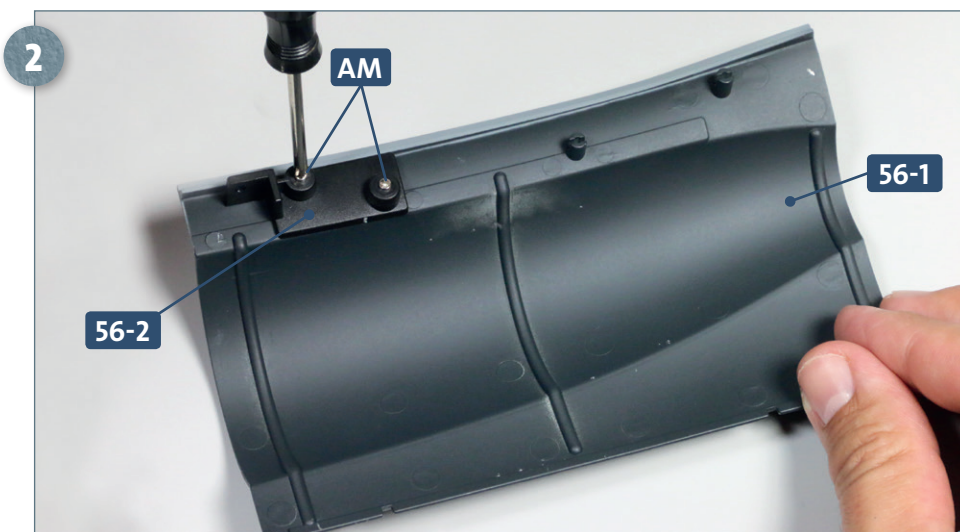

Fix connector 56-2 in place with two AM screws, as shown.



Next place connector 56-3 on the hull plate 56-1 and secure it in position using the two remaining AM screws, as pictured.

Kit 56: Port hull section

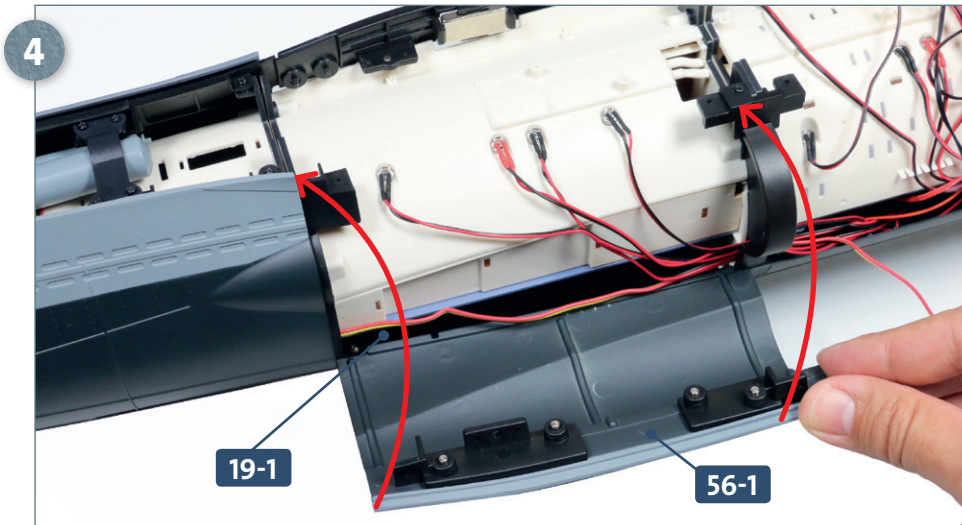

Take the hull section **56-1** and insert its bottom edge behind the top edge of the lower hull section **19-1**. The plate is then swivelled upwards, as indicated by the two arrows.

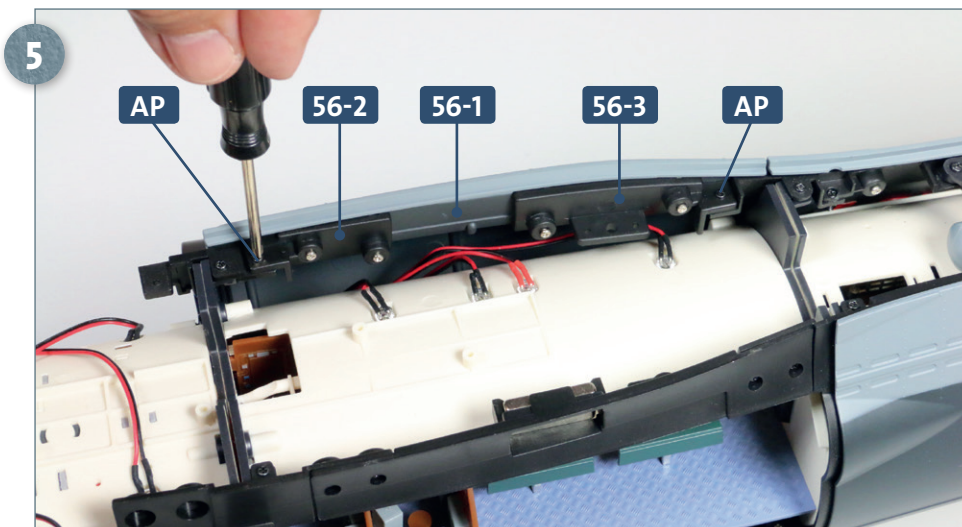

Attach the hull plate **56-1** to the main hull assembly using an **AP** screw into the holes in each of the two connectors **56-2** and **56-3**, as shown.

COMPLETED WORK



A new hull section has been added to the build.